

SERIES 5
12 O’CLOCK CABINET
Instructions For Use

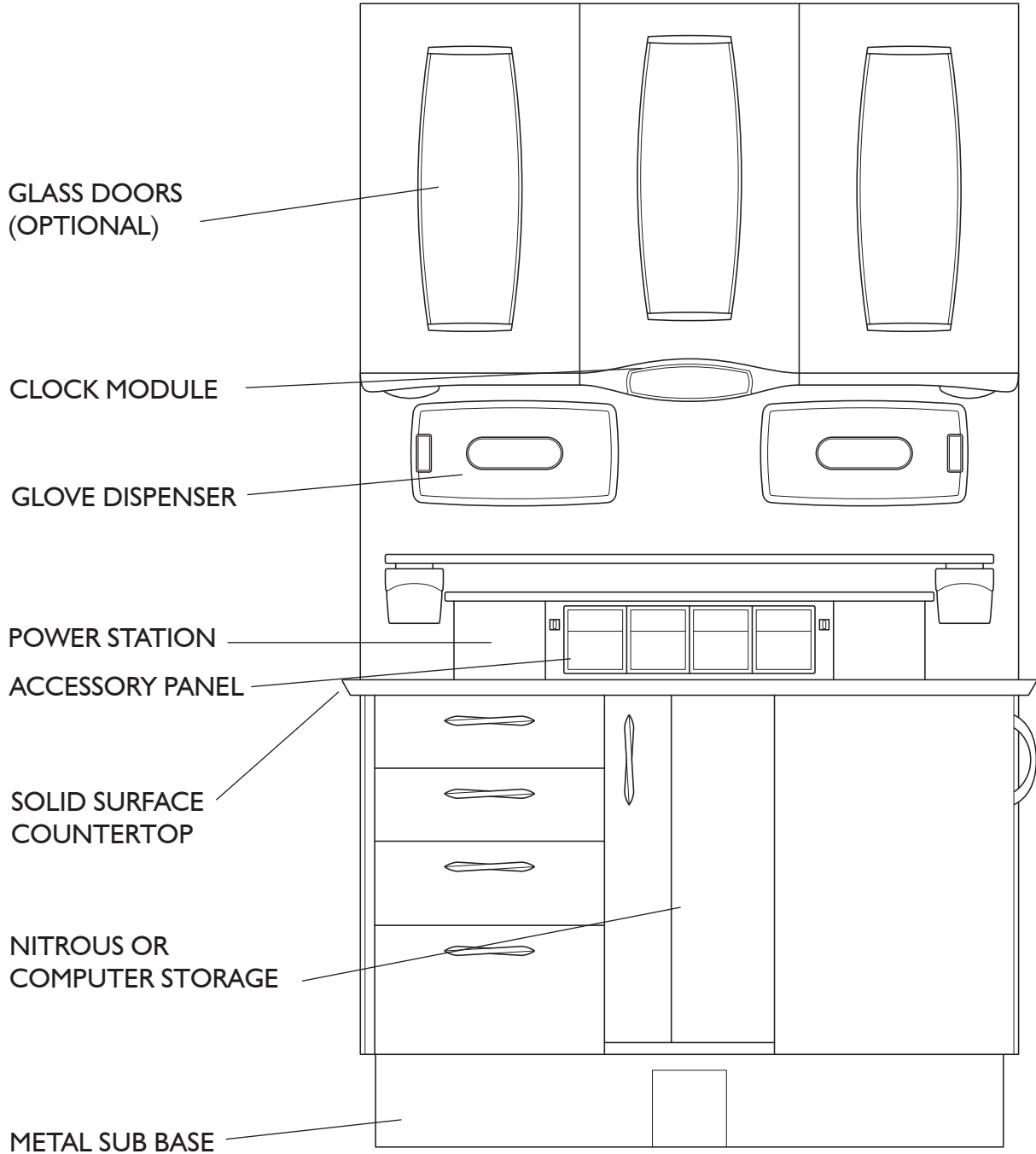

INTRODUCTION

SYMBOLS

The following symbols may be used throughout this product manual:



CAUTION: General Caution. Failure to carefully follow the described procedure may result in damage to the equipment.



WARNING: Failure to carefully follow the described procedure may result in damage to the equipment, the operator, and/or the operator.



ELECTRICAL HAZARD: Risk of electrical shock present. Ensure that power is disconnected before attempting this procedure.



NOTE: Take note of additional important information. Not a warning or caution.



Manufacturer



Manufacturing date



Waste Electrical and Electronic Equipment



Type B Equipment (Protected against electrical shock)



Protective Earth (ground)



Alternating Current



Conforms to applicable European Directives (Essential Requirements)



Electrical Testing Lab



Advisable to consult accompanying documents

TABLE OF CONTENTS

System Overview	2
Introduction	3
General Information	4
General Safety	5
Operating Clock Timer & Lighting	6
Power Station	7
Ergo Shelves	8
Static Shelf	9
Glove Dispensers	10
Disinfection and Cleaning	11

GENERAL INFORMATION

INTENDED APPLICATION AND USE

The DCI Edge 12 O'Clock Cabinet provides storage, work surfaces, and support for delivery units and accessory devices.

PRODUCT IDENTIFICATION

The DCI Edge 12 O'Clock Cabinet can be identified by the label on the left-most interior panel. This label states the model number, serial number, electrical specifications, manufacturing date, and safety classifications.

ENVIRONMENTAL CONDITIONS

Operating Conditions:	Shipping conditions:
Temperature: 67-76° F	Temperature: -68 - 122° F
Humidity: 20-60%	Humidity: 10-90%
Altitude: <5,000 m	

ELECTRICAL OUTLETS

125VAC 20A 60Hz

INCOMPATIBLE DEVICES

For safety reasons, only DCI original devices and accessories approved for this product, or accessories from third parties released by DCI may be used.

PRODUCT DISPOSAL

Contact your local, authorized dealer for disposal of this device to ensure compliance with your local environmental regulations.

TECHNICAL DOCUMENTATION

The manufacturer will make available upon request circuit diagrams, component part lists, descriptions, and calibration instructions to technical personnel responsible for the installation and service of this equipment.

PREVENTATIVE INSPECTION

The performance of the equipment can be affected by use over time. Periodically inspect the water and air lines for visible cracks or cuts, and inspect for loose fittings and fasteners which could lead to leaks or other poor performance characteristics. Inspect joints and tensioning screws as a regular maintenance item to ensure proper positioning of the device.

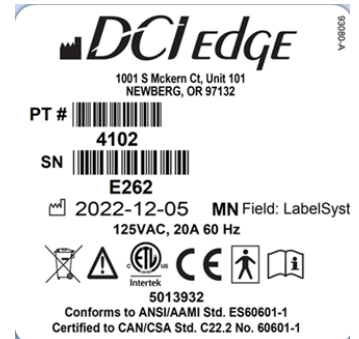
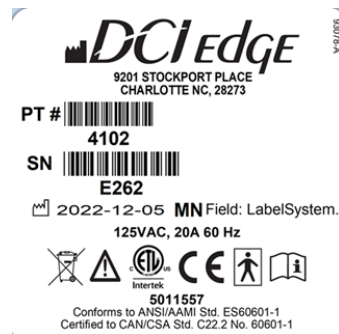

GENERAL SAFETY

IMPORTANT SAFETY INSTRUCTIONS



WARNING: This product must be disinfected before use.



CAUTION: Only authorized service technicians should attempt to service this equipment. Use of other than authorized technicians will void the warranty.



CAUTION: Product must be bolted to the floor and support wall before use.



WARNING: To avoid risk of electric shock, this equipment must be connected only to supply mains with protective earth.



WARNING: Modification of this equipment is not allowed.



WARNING: Failure to disinfect this device between patients could expose the user and patient to cross contamination and bioburden/biocontamination.



WARNING: Do not allow children unsupervised access to this cabinet and auxiliary equipment.



WARNING: Use this cabinet only for its intended use as described in these instructions. Do not use attachments not recommended by the manufacturer.



WARNING: Do not use outdoors.



WARNING: Do not exceed the breaker rating of the breakers for the circuits dedicated to the outlets in the cabinets. Consult your local electrician for more information.

SAVE THESE INSTRUCTIONS

OPERATION - CLOCK TIMER AND LIGHTING CONTROL

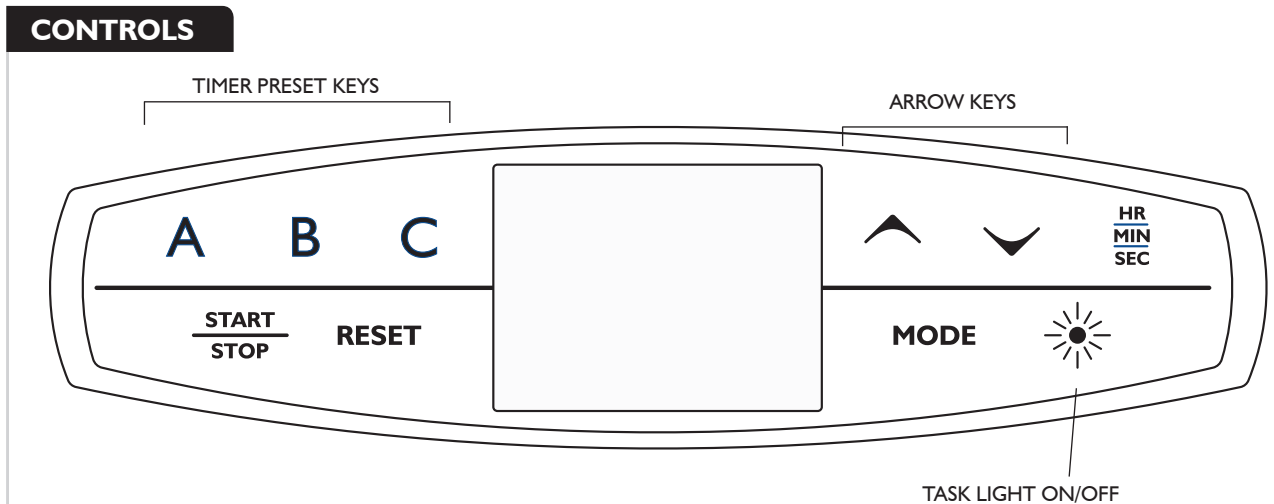

PRESS LIGHT ON/OFF to toggle the LED task lighting on or off

SET CLOCK: Press and hold the “MODE” key for 3 seconds to set the clock.
Press ARROW UP and ARROW DOWN keys to adjust the minutes.
Press Hr/Min/Sec to Switch to editing hours, and then adjust with arrow keys.
Press Hr/Min/Sec to Switch to editing day of the week, and then adjust with arrow keys.
Press Hr/Min/Sec to Switch to editing day of the month, adjust with arrow keys.
Press Hr/Min/Sec to Switch to editing the month, adjust with arrow keys.
Press Hr/Min/Sec to Switch to editing the year, adjust with arrow keys.
Press Hr/Min/Sec to return back to editing minutes.
Exit CLOCK SETTING MODE by pressing START/STOP or MODE.

TIMER MODE:

Press MODE once from the CLOCK display to enter TIMER MODE.
Press ARROW UP and ARROW DOWN keys to adjust minutes, adjust with arrow keys.
Press Hr/Min/Sec to switch to editing seconds. Adjust with arrow keys.
Press START/STOP to begin countdown of currently displayed time.
Press START/STOP to pause the countdown.

Using Timer Presets (From Clock or Timer mode)

Press PRESET A, B, or C for quick access to pre-programmed PRESET times.
Press START/STOP to begin the timer. Press again to pause.

Programming Timer Presets

While in Timer Mode, use the arrow keys to adjust the timer to the desired amount of time.
Press and hold the PRESET A, B, or C key for 3 seconds to store the time into memory.

STOPWATCH MODE: Press MODE twice from CLOCK MODE to enter STOPWATCH MODE

Press START/STOP to begin counting up of currently displayed time.
Press START/STOP to pause the counting.
Press RESET to return to 00:00.
Press MODE to go to CLOCK.



NOTE: To briefly check the clock time while in TIMER MODE or STOPWATCH MODE, press and hold MODE. Release to return to the previously displayed screen.

POWER STATION

FEATURES

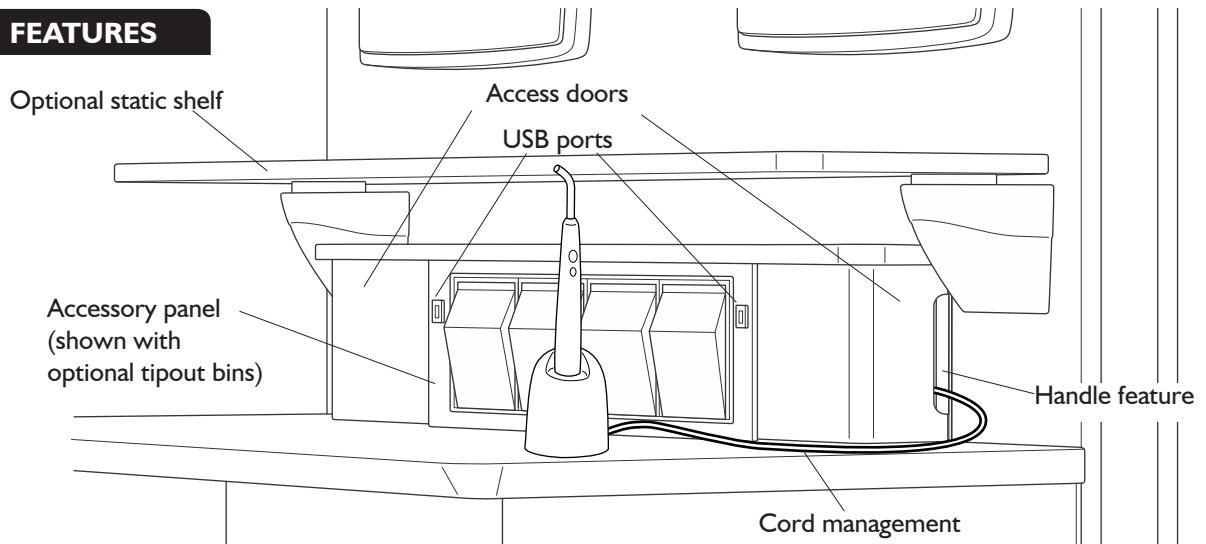

1. USB ports are found at the front of the power station on the accessory panel. These can be plugged into a computer for data communication or to a power supply (not provided) for charging devices.
2. Duplex outlets are found behind the access door on each side of the power station inside of the support wall. Access doors are latched magnetically and can be opened by grasping the handle feature shown above.
3. After plugging in your ancillary device to the duplex outlet and placing it on the countertop, the excess cord length can be stored inside the support wall cavity.
4. Close the access door and allow the power cord of the device to pass through the opening formed by the handle feature of the door as shown above.

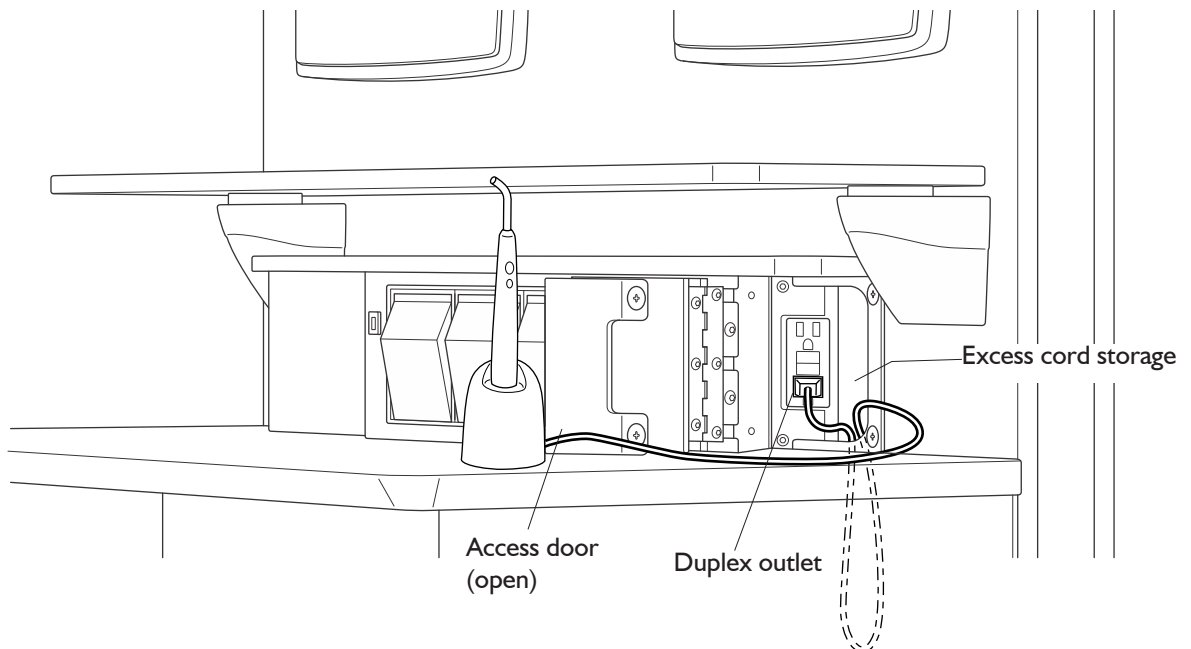

ERGO SHELVES (OPTIONAL)

FEATURES

1. Ergo Shelves are rated for a maximum load of 10 lbs per shelf.
2. Ergo Shelves include plastic covers which allow for cable management through the arms.
3. Use the cable strap to keep the cable managed inside the channel.
4. Remove the plastic cover (not shown) to route the cable through the hole in the mount casting and into the wall.
5. Reach into the wall through the access door of the power station to plug the power cable into the duplex outlet located inside the support wall.
6. The included rubber mat can be removed and replaced if desired if damaged.
7. Tension the pivots by removing the plastic cover, removing the thread locking screw, and then tightening or loosening the nut with a hex wrench inserted into the hex shaped hole. (see right) Once the adjustments are complete, replace the thread locking screw to maintain a consistent tension during use.

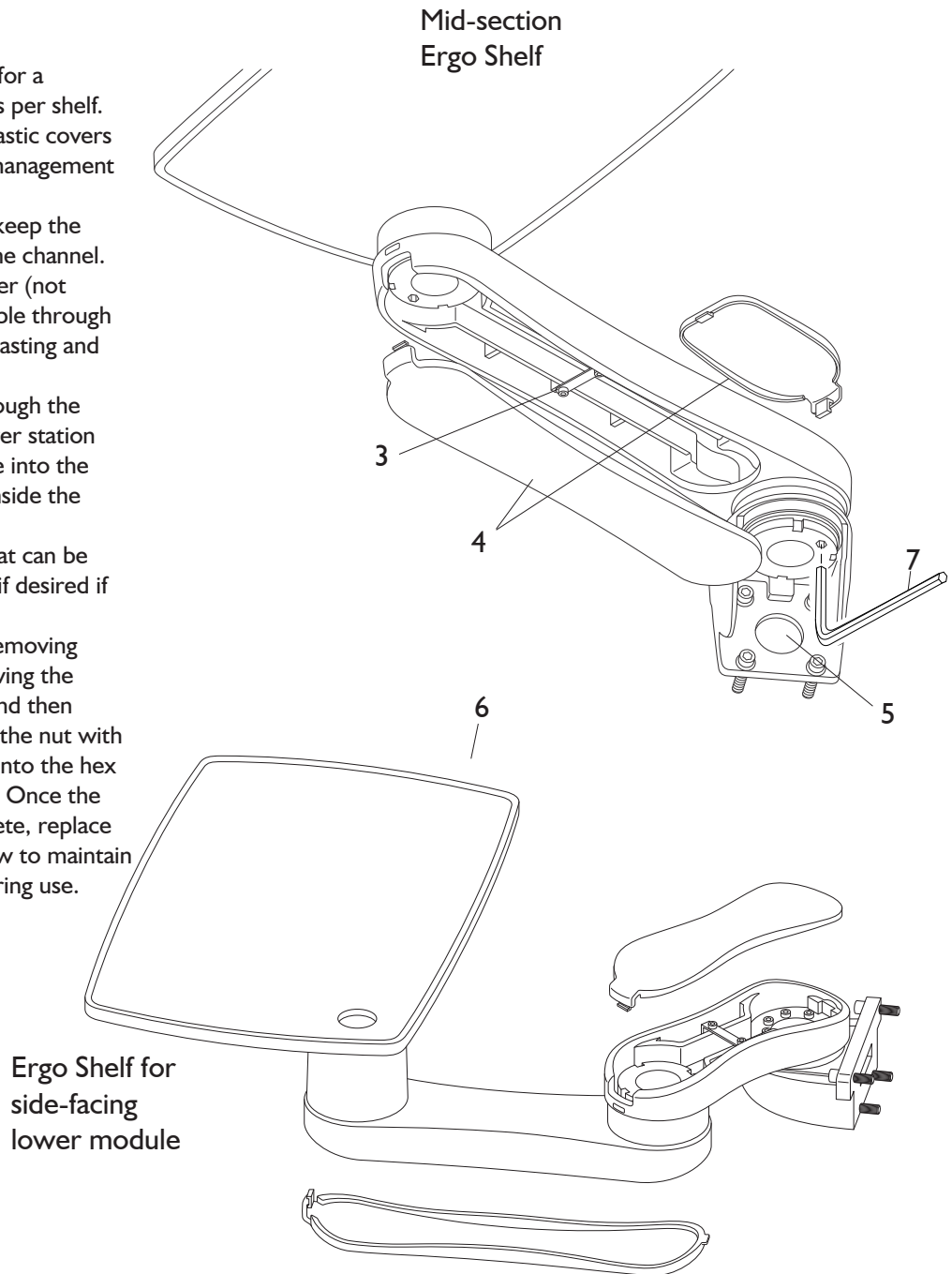

CAUTION: Exceeding the 10 lb load rating of the Ergo Shelf may result in injury or cause damage to the equipment.

STATIC SHELF (OPTIONAL)

FEATURES

1. The Static Shelf includes a hole at each back corner for routing cables for electrical devices you wish to keep stored and powered there.
2. Remove the plastic cover from the lower mount to route the cable through the hole in the mount casting and into the wall.
3. Reach into the wall through the access door to plug the power cable into the duplex outlet located inside the support wall.
4. Manage excess cable length by allowing it to fall down inside the wall.

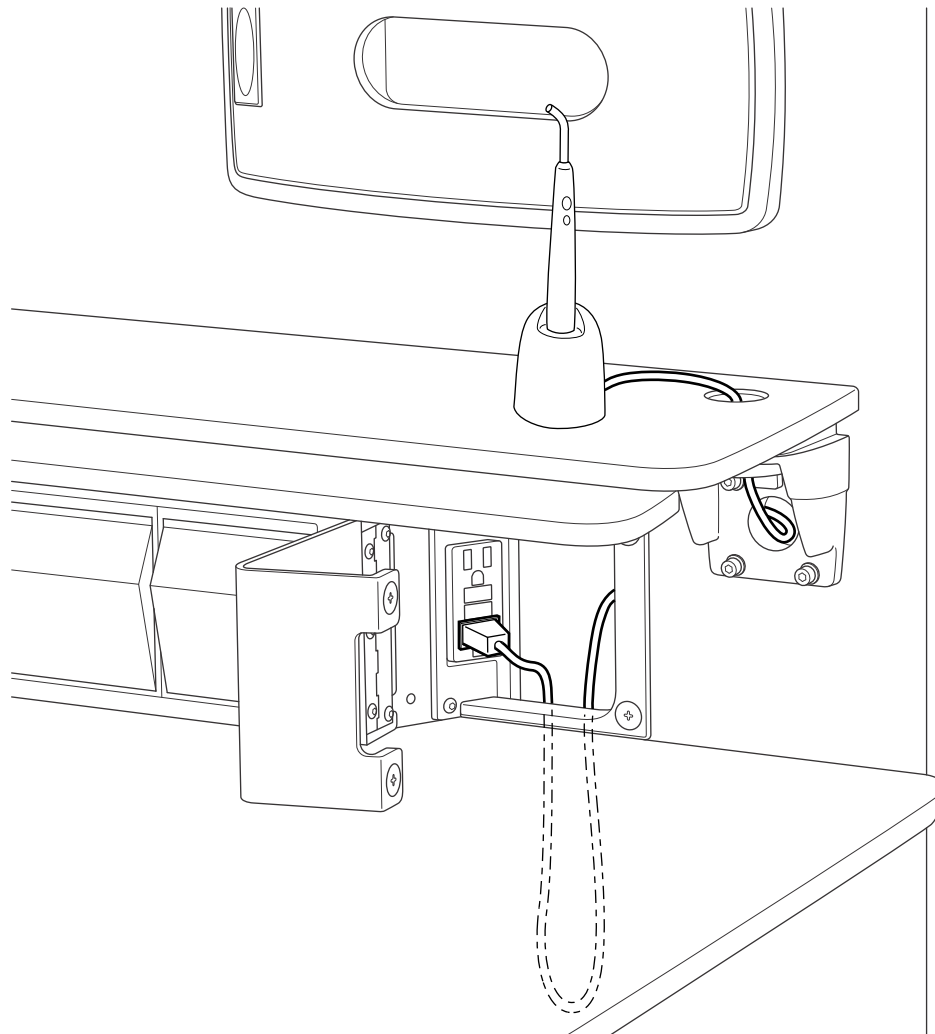

GLOVE DISPENSERS (OPTIONAL)

MID-SECTION GLOVE DISPENSER

1. Replace glove box by first depressing the button and pulling the the glove panel forward.
2. Pull the tab on the elastic cord to release it from the hook.
3. Remove the perforated opening on the new glove box and install the open face against the panel.
4. Stretch the elastic cord over the box using the pull tab and catch it over the hook.
5. Reinstall the glove panel into the plastic bezel by inserting the hook end into the opening opposite the button side, then snap the panel into place.

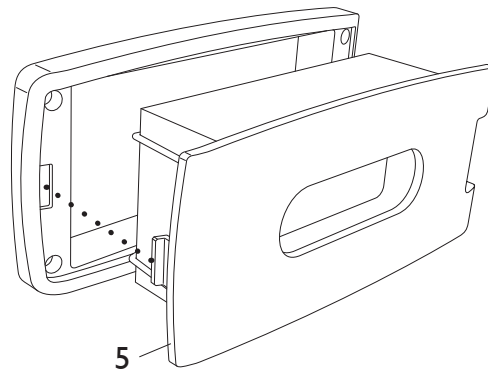
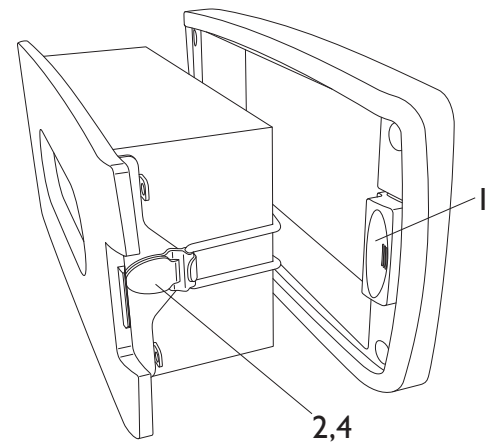

UPPER GLOVE DISPENSER

1. Pull tab to release the elastic cord from the hook.
2. Remove the perforated opening on the new glove box and install the open face against the bracket.
3. Stretch the elastic cord over the box using the pull tab and catch it over the hook.

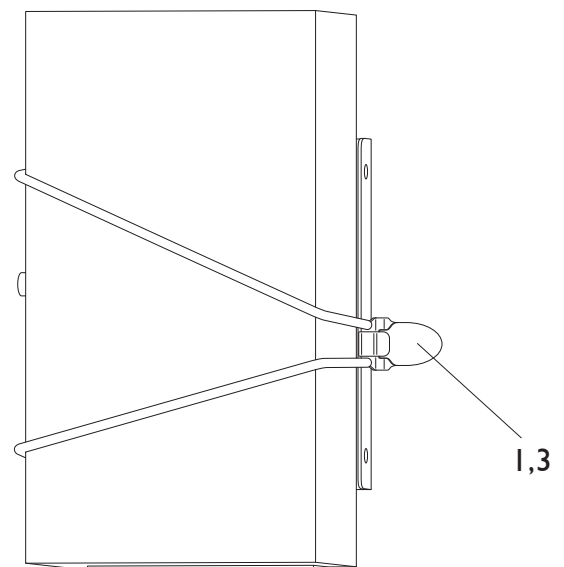

DISINFECTION AND CLEANING

BARRIER TECHNIQUE

Wherever possible, use disposable barriers and change them between patients. The barrier technique will ensure maximum long-term durability of the surfaces and finishes of the equipment.

DISINFECTION & STERILIZATION

The Manufacturer will not attempt to specify the required intervals for disinfection nor can it recommend the overall best surface disinfectant. Please refer to the Infection Control Recommendations published by the American Dental Association for further information. The use of chemical disinfecting agents is not necessary if the instrument is going to be sterilized. While their use may be easy and quick, it is important to know the effectiveness of any chemical disinfectant against the various agents of infection that may be encountered.

CHEMICAL DISINFECTION

Follow the instructions below carefully to ensure the longest life for your equipment:

1. Only use the acceptable disinfectants listed. Use of unacceptable products will void your warranty.
2. Do not spray disinfectant chemicals directly on surfaces. Spray a cloth and wipe the surfaces with the cloth. Manufactured disinfectant wipes are recommended.
3. Thoroughly wash all areas that have been exposed to disinfectant cleaners with mild soap and warm water at least once per day. This wash down will minimize the harmful effects of chemical disinfectant residues being allowed to accumulate on the equipment.
4. When using chemical disinfectants, always pay strict attention to the manufacturer's disinfectant directions.
5. When using concentrated disinfectants, measure the concentrate carefully and mix according to package

Conditionally Acceptable Disinfectants

Phthalaldehyde
Quarternary Ammonium
Glutaraldehyde



CAUTION: These disinfectants will harm the surface finish of dental equipment and are not recommended.

Unacceptable:

Strong Phenols/Phenol Alcohol combinations
Sodium Hypochlorite/Household Bleach
Sodium Bromide
Strong Alcohol
Household Cleaners (Dental Equipment Only)
Citric Acids
Iodophors
Ammonium Chloride
Accelerated Hydrogen (0.5%)

GENERAL CLEANING

Equipment can be cleaned with a solution of mild detergent and warm water. A variety of surface disinfectants are available for use in dental treatment rooms. Some of these can cause discoloration of painted, plated or anodized surfaces with repeated use. This can be minimized by careful adherence to the disinfectant manufacturer's instructions and by frequent washing with soap and water.



CAUTION: Do not use powdered cleansers, scouring pads or abrasive scrubbers on any of the painted, plastic or metal surfaces of this dental unit. To remove dried-on material, use a soft-bristled brush and a solution of mild detergent.

